



360° Performance™

360<sup>+1</sup>

### Better Performance

- Painted Cabinets
- 1008 Hrs Salt Spray (ASTM-B117)
- Scroll Compressor
- System Protections
- Metal coil Guard
- Metal Fan and Fan Guard
- Metal Blower and housing
- Energy Efficient ECM
- Composite Base pan
- Optimized fan orifice
- Modern cabinet aesthetics
- Visual brand language

MODEL	T1 EER	T1 CAPACITY
18	12.15	17000
22 & 24	11.85	22000
28 & 30	11.8	26400
32 & 36	11.85	32000
42	11.80	43600
48	12.85	48000
55	12.10	52000
65	12.10	62000

**بطاقة كفاءة الطاقة**  
ENERGY EFFICIENCY LABEL

المهنة السعودية للمواصفات والمقاييس والجودة  
Saudi Standards, Metrology and Quality Org.

**AIR CONDITIONER** | مكيف الهواء

**التدفئة**  
HEATING

لا تنطبق  
NOT APPLICABLE

**التبريد**  
COOLING

CAPACITY  
KW (Btu/h) **7.75 (26400)** السعة  
كيلووات (ب.ت.س)

EER  
BTU / (h.W) **11.80** نسبة كفاءة الطاقة  
(ب.ت.س/ب.ت.س)

ANNUAL ENERGY CONSUMPTION  
KWh **6034** الاستهلاك السنوي  
كيلوواط ساعة

منفصل SPLIT  شباكك WINDOW النوع TYPE

MADE IN **Mexico** بلد المنتج BRAND NAME **Rheem** العلامة التجارية

MODEL NUMBER **EL3T2812SPBCJA030 EA1430AJ1NB030** رقم الطراز

رقم التسجيل **E01144/2019** REGISTRATION NO

STANDARD REFERENCE NO **SASO 2663/2018** الرقم المرجعي للمواصفة

إزالة أو تغطية أو العبث بهذه البطاقة قبل البيع يجعلك عرضة للمسؤولية النظامية  
Removing, covering or altering this label before sale can subject you to legal liability



360° Performance™

360<sup>+1</sup>

Better Performance

Painted Cabinets

1008 Hrs Salt Spray (ASTM-B117)

Scroll Compressor

System Protections

Metal coil Guard

Metal Fan and Fan Guard

Metal Blower and housing

Energy Efficient ECM

Composite Base pan

Optimized fan orifice

Modern cabinet aesthetics

Visual brand language



- Polyester based Powder painted, sheet metal for high corrosion resistance

**Benefit:**

- Long life
- Elegant look.



360° Performance™

360<sup>+1</sup>

Better Performance  
Painted Cabinets  
**1008 Hrs Salt Spray (ASTM-B117)**  
Scroll Compressor  
System Protections  
Metal coil Guard  
Metal Fan and Fan Guard  
Metal Blower and housing  
Energy Efficient ECM  
Composite Base pan  
Optimized fan orifice  
Modern cabinet aesthetics  
Visual brand language



- 1008 hrs salt spray test as per ASTM-B117 std.

**Benefit:**

- Long life
- No corrosion of panels
- Elegant look.



360° Performance™

360<sup>+1</sup>

Better Performance  
Painted Cabinets  
1008 Hrs Salt Spray (ASTM-B117)  
**Scroll Compressor**  
System Protections  
Metal coil Guard  
Metal Fan and Fan Guard  
Metal Blower and housing  
Energy Efficient ECM  
Composite Base pan  
Optimized fan orifice  
Modern cabinet aesthetics  
Visual brand language



- Emerson (Copeland) make Scroll Compressor Specially designed for High Ambient and High Efficiency application.
- Internally spring mounted and externally mounted on rubber grommets - reduced vibration and noise.
- Internal Pressure Relief - protect against excessive pressure differential.

- High Efficiency
- Proven for reliability
- Suitable for High Ambient
- Reason to trust (Emerson)



360° Performance™

360<sup>+1</sup>

Better Performance  
Painted Cabinets  
1008 Hrs Salt Spray (ASTM-B117)  
Scroll Compressor

**System Protections**

Metal coil Guard  
Metal Fan and Fan Guard  
Metal Blower and housing  
Energy Efficient ECM  
Composite Base pan  
Optimized fan orifice  
Modern cabinet aesthetics  
Visual brand language



- HP and LP safety controls are a standard feature on all the models.
- HP/LP Interlocked with controller.
- Anti Short Cycle control standard

**Benefit :**

- Increased compressor and system reliability.
- Long life



360° Performance™

360<sup>+1</sup>

Formed and slotted corner posts



Formed curved louver panel

Better Performance  
Painted Cabinets  
1008 Hrs Salt Spray (ASTM-B117)  
Scroll Compressor  
System Protections  
**Metal coil Guard**  
Metal Fan and Fan Guard  
Metal Blower and housing  
Energy Efficient ECM  
Composite Base pan  
Optimized fan orifice  
Modern cabinet aesthetics  
Visual brand language

- Metallic louver guard Helps reducing chocking of coil
- Avoids mechanical damage to coils
- Pressed parts like Base, Top, Side grilles makes cabinet sturdy

**Benefit :**

- Long life
- Less chocking of coils
- Elegant look
- Sturdiness



360° Performance™

360<sup>+1</sup>



- Better Performance
- Painted Cabinets
- 1008 Hrs Salt Spray (ASTM-B117)
- Scroll Compressor
- System Protections
- Metal coil Guard
- Metal Fan and Fan Guard**
- Metal Blower and housing
- Energy Efficient ECM
- Composite Base pan
- Optimized fan orifice
- Modern cabinet aesthetics
- Visual brand language



### FAN / FAN GUARD

Metallic Condenser fan blades ensure safety & high durability. Metallic wire guard confirms to IEC safety standard & high durability

**Benefit :**

- Longer life



360° Performance™

360<sup>+1</sup>

Better Performance  
Painted Cabinets  
1008 Hrs Salt Spray (ASTM-B117)  
Scroll Compressor  
System Protections  
Metal coil Guard  
Metal Fan and Fan Guard  
**Metal Blower and housing**  
Energy Efficient ECM  
Composite Base pan  
Optimized fan orifice  
Modern cabinet aesthetics  
Visual brand language



### Metallic Indoor Blower

Metallic Indoor Blower ensure safety & high durability.

### Metallic Blower Housing

Metallic Indoor Blower housing ensure no air leakage thru joints

#### **Benefit :**

- Longer life





360° Performance™

360<sup>+1</sup>



Better Performance  
Painted Cabinets  
1008 Hrs Salt Spray (ASTM-B117)  
Scroll Compressor  
System Protections  
Metal coil Guard  
Metal Fan and Fan Guard  
Metal Blower and housing  
**Energy Efficient ECM**  
Composite Base pan  
Optimized fan orifice  
Modern cabinet aesthetics  
Visual brand language

## EC MOTOR in Indoor Units

- Energy Efficient BLDC motors
- Constant Torque – Good for high external static pressure
- Multi speed
- Internally protected
- Mounted on resilient neoprene rubber to reduce noise and vibration.
- Permanently lubricated
- Reputed Brand

### **Benefit :**

- Low vibration
- Low noise
- Increased reliability
- Reduced Energy bill



360° Performance™

360<sup>+1</sup>

- Better Performance
- Painted Cabinets
- 1008 Hrs Salt Spray (ASTM-B117)
- Scroll Compressor
- System Protections
- Metal coil Guard
- Metal Fan and Fan Guard
- Metal Blower and housing
- Energy Efficient ECM
- Composite Base pan**
- Optimized fan orifice
- Modern cabinet aesthetics
- Visual brand language

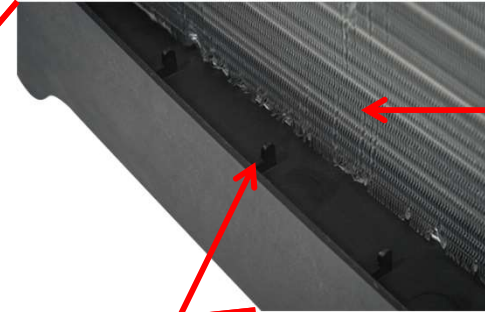

Condenser Coil

Pan Captures Louver Panel

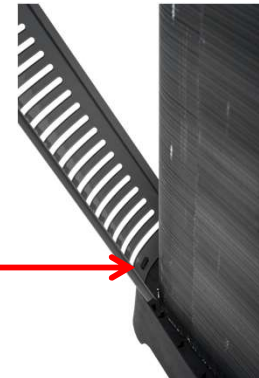

Notch for Capturing Corner Post

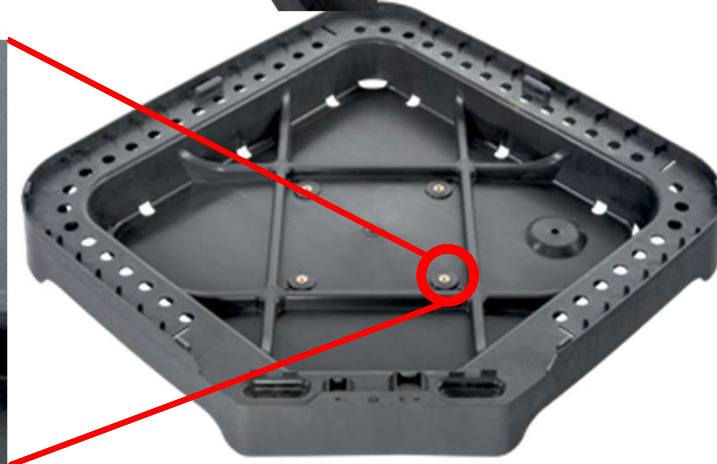

**Benefit :**

- Reduces Fasteners
- Eliminates corrosion
- Dampens vibration
- Lighter weight
- Rigidity



360° Performance™

360<sup>+1</sup>

- Better Performance
- Painted Cabinets
- 1008 Hrs Salt Spray (ASTM-B117)
- Scroll Compressor
- System Protections
- Metal coil Guard
- Metal Fan and Fan Guard
- Metal Blower and housing
- Energy Efficient ECM
- Composite Base pan
- Optimized fan orifice
- Modern cabinet aesthetics
- Visual brand language

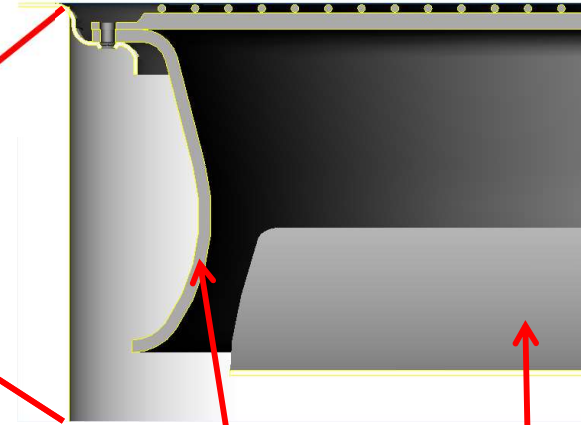

*Optimized fan venturi*

*Fan Blade*

**Benefit :**

- Reduced sound levels
- Increased air flow
- Improved Thermal performance hence efficiency
- Reduced Energy bills





360° Performance™

360<sup>+1</sup>

- Better Performance
- Painted Cabinets
- 1008 Hrs Salt Spray (ASTM-B117)
- Scroll Compressor
- System Protections
- Metal coil Guard
- Metal Fan and Fan Guard
- Metal Blower and housing
- Energy Efficient ECM
- Composite Base pan
- Optimized fan orifice
- Modern cabinet aesthetics
- Visual brand language

Warm Dark Gray Post painted cabinet

Top Cap & Label

Radius Corners & Top

Black rust resistant screws

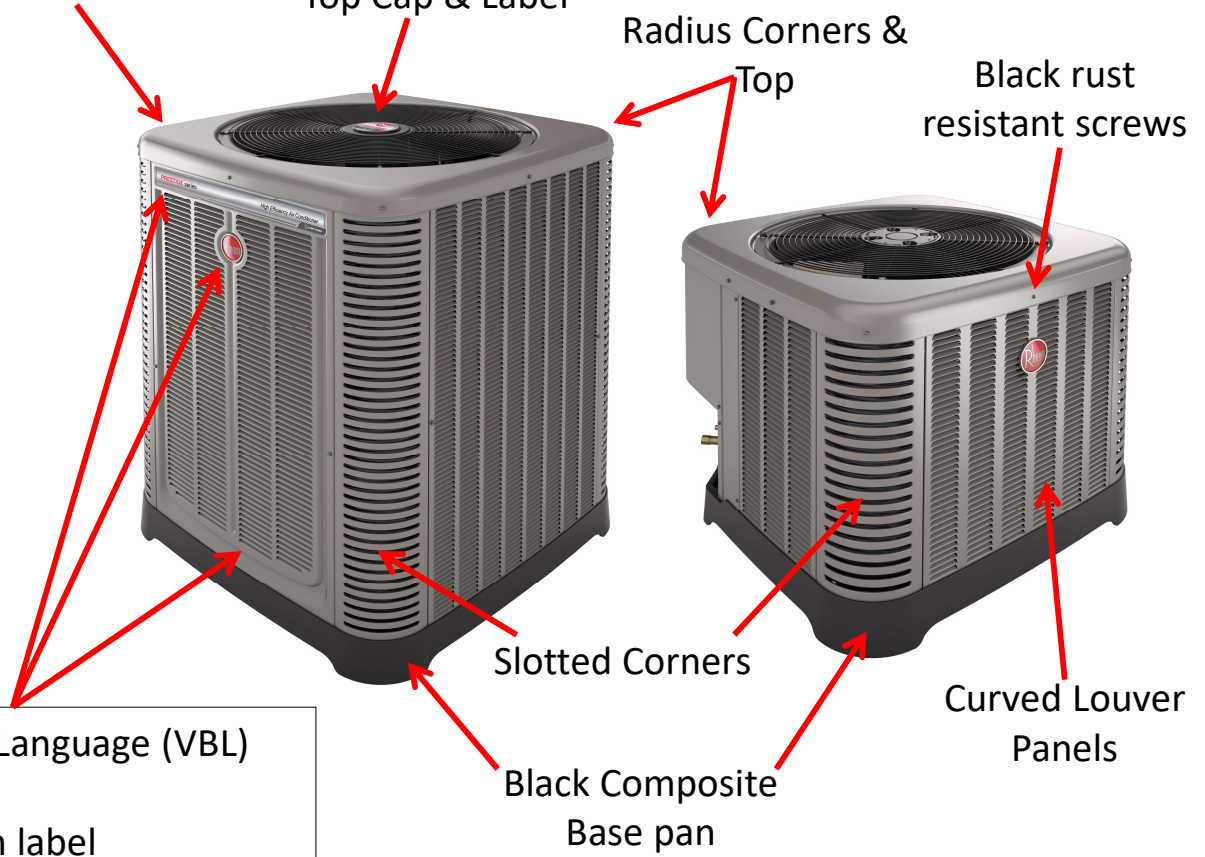

- Visual Brand Language (VBL)
- Louver label
  - Top cap with label
  - 3D Rheem Badge

- Benefit :**
- Elegant look
  - Premium image



360° Performance™

360<sup>+1</sup>





360° Performance™

360<sup>+1</sup>



PlusOne™  
Energy Efficiency



## Features

- EERs up to 12.85
- Higher actual capacities

## Benefits

- Reduce power consumption at high ambient temp



360° Installability™

360°<sup>+1</sup>

**Sturdy cabinet**

- 15" wide control box
- External gauge ports
- Service trays
- Integrated lift receptacles (Optional)
- Easy handling
- No sharp edges
- 10.5" High-Slim Air Handlers
- Convertible return air arrangement
- Provision for ½" & 1" filter
- Easy Hi/Lo voltage hookup
- Flexibility in drain connection

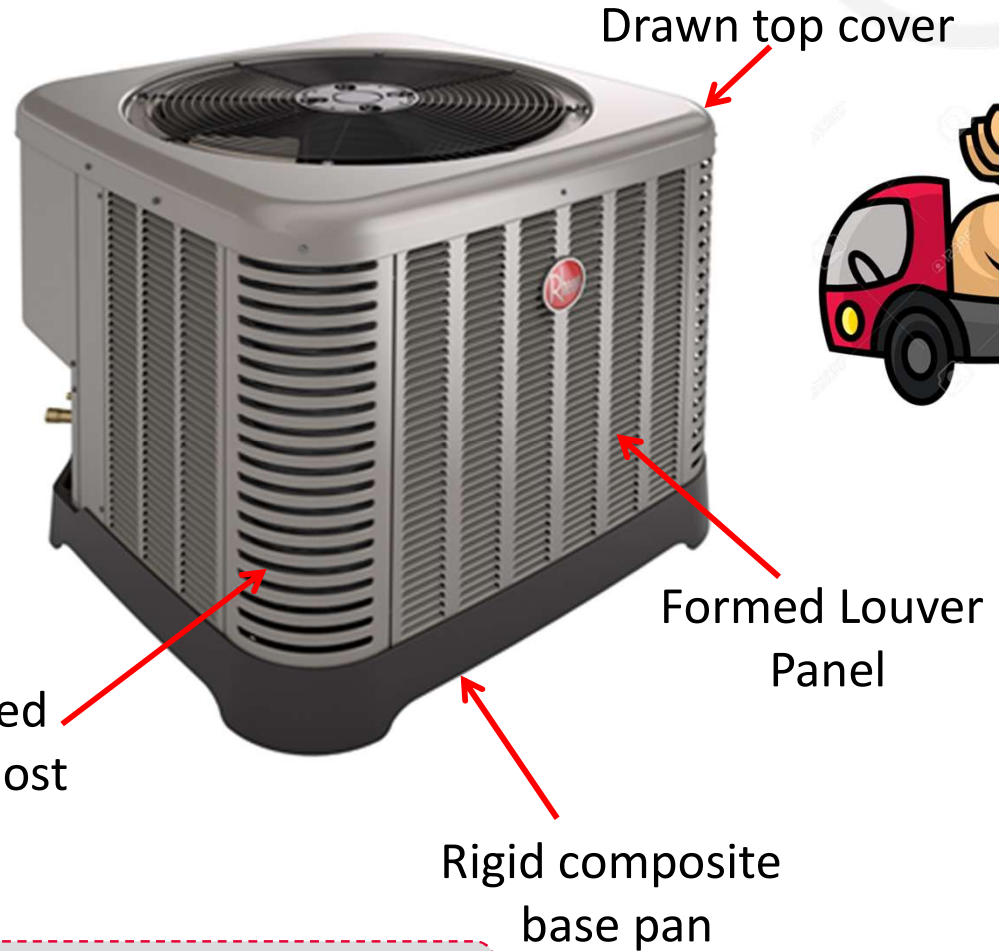

**Benefit :**

- Increase panel strength
- Low vibration
- Low noise
- Increased reliability



360° Installability™

360<sup>+1</sup>

- Sturdy cabinet
- 15" wide control box
- External gauge ports
- Service trays
- Integrated lift receptacles (Optional)
- Easy handling
- No sharp edges
- 10.5" High-Slim Air Handlers
- Convertible return air arrangement
- Provision for ½" & 1" filter
- Easy Hi/Lo voltage hookup
- Flexibility in drain connection







360° Installability™

360<sup>+1</sup>

- Sturdy cabinet
- 15" wide control box
- External gauge ports
- Service trays
- Integrated lift receptacles (Optional)
- Easy handling
- No sharp edges
- 10.5" High-Slim Air Handlers
- Convertible return air arrangement
- Provision for ½" & 1" filter
- Easy Hi/Lo voltage hookup
- Flexibility in drain connection



## REFRIGERANT CONNECTIONS

- Connections soldered type on exterior of the unit
- located close to the ground for neat appearing installation.

## SERVICE VALVES

- Standard on all models.
- Outside the unit with service port for connecting gauges for ease of installation, additional refrigerant charging and monitoring of system.

### Benefit :

- Easy to install
- Saves time



EASY INSTALL



360° Installability™

360<sup>+1</sup>

- Sturdy cabinet
- 15" wide control box
- External gauge ports
- Service trays**
- Integrated lift receptacles (Optional)
- Easy handling
- No sharp edges
- 10.5" High-Slim Air Handlers
- Convertible return air arrangement
- Provision for ½" & 1" filter
- Easy Hi/Lo voltage hookup
- Flexibility in drain connection





360° Installability™

360<sup>+1</sup>

- Sturdy cabinet
- 15" wide control box
- External gauge ports
- Service trays
- Integrated lift receptacles  
(Optional)
- Easy handling
- No sharp edges
- 10.5" High-Slim Air Handlers
- Convertible return air  
arrangement
- Provision for ½" & 1" filter
- Easy Hi/Lo voltage hookup
- Flexibility in drain connection





360° Installability™

360°<sup>+1</sup>

- Sturdy cabinet
- 15" wide control box
- External gauge ports
- Service trays
- Integrated lift receptacles (Optional)
- Easy handling**
- No sharp edges
- 10.5" High-Slim Air Handlers
- Convertible return air arrangement
- Provision for ½" & 1" filter
- Easy Hi/Lo voltage hookup
- Flexibility in drain connection





360° Installability™

360°<sup>+1</sup>

- Sturdy cabinet
- 15" wide control box
- External gauge ports
- Service trays
- Integrated lift receptacles (Optional)
- Easy handling
- No sharp edges**
- 10.5" High-Slim Air Handlers
- Convertible return air arrangement
- Provision for ½" & 1" filter
- Easy Hi/Lo voltage hookup
- Flexibility in drain connection

Post paint



Composite base pan  
(Elevated for ease of handling)



360° Installability™

360<sup>+1</sup>

Sturdy cabinet  
15" wide control box  
External gauge ports  
Service trays  
Integrated lift receptacles  
(Optional)  
Easy handling  
No sharp edges  
**16.57" High-Slim Air Handlers**  
Convertible return air  
arrangement  
Provision for ½" & 1" filter  
Easy Hi/Lo voltage hookup  
Flexibility in drain connection



- 26 cm (10.5") height **up to model 32**
- 40.8 cm (16.07") height from model 42 to 55
- 42 cm (16.57") height for model 65
- Can go easily in tight space

**Benefit :**

- Easy to install
- Easy installation in tight space
- Leaves more space for service



360° Installability™

360<sup>+1</sup>

- Sturdy cabinet
- 15" wide control box
- External gauge ports
- Service trays
- Integrated lift receptacles (Optional)
- Easy handling
- No sharp edges
- 10.5" High-Slim Air Handlers
- Convertible return air arrangement (Up to model 32)
- Provision for ½" & 1" filter
- Easy Hi/Lo voltage hookup
- Flexibility in drain connection

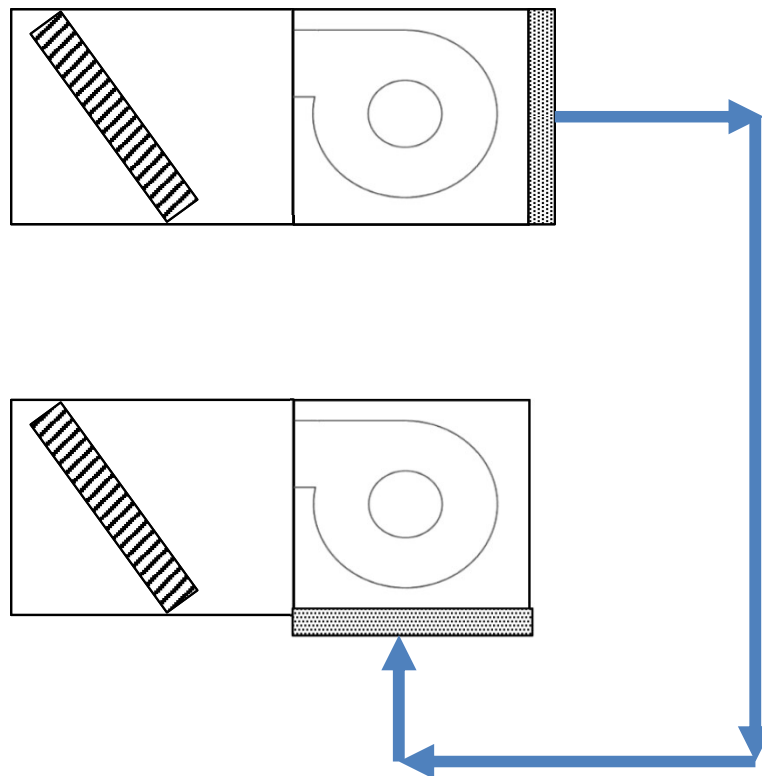

Up to  
Model 32

**Benefit :**

- Installation flexibility
- Save space



360° Installability™

360<sup>+1</sup>

- Sturdy cabinet
- 15" wide control box
- External gauge ports
- Service trays
- Integrated lift receptacles (Optional)
- Easy handling
- No sharp edges
- 10.5" High-Slim Air Handlers
- Convertible return air arrangement
- Provision for ½" & 1" filter
- Easy Hi/Lo voltage hookup
- Flexibility in drain connection

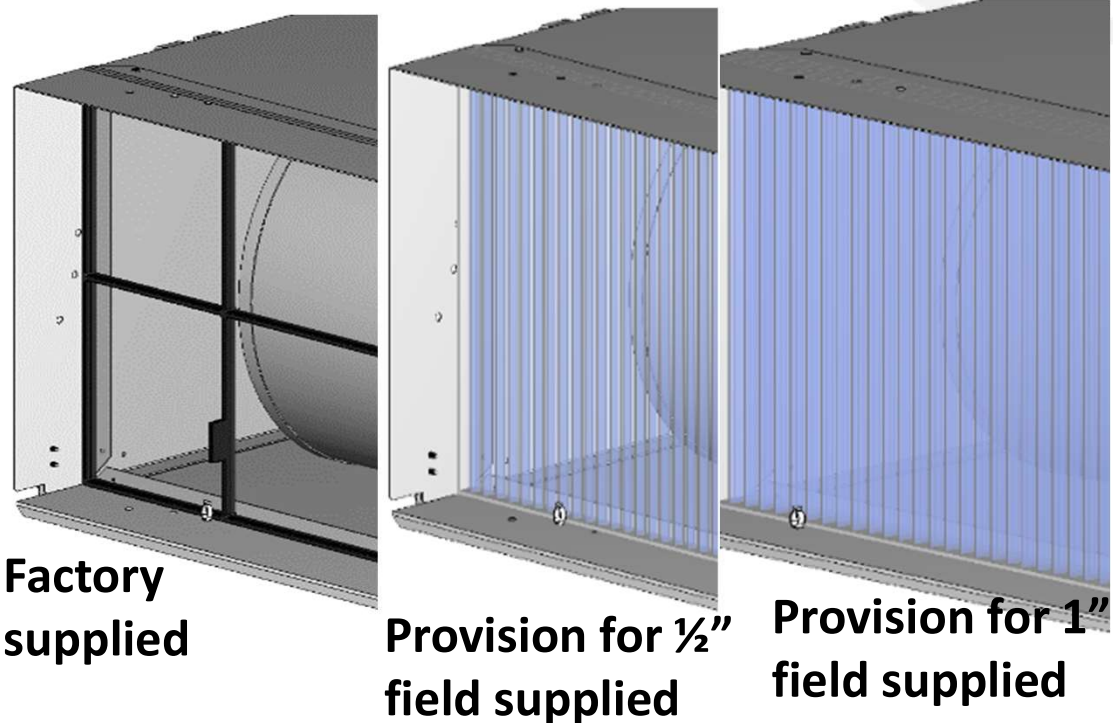

### Filter arrangement flexibility

- Bottom access to filter
- Easy to remove in case of return air ducting
- Provision to accommodate ½" & 1" field supplied filter

#### **Benefit :**

- **Ease of service**
- **Installation flexibility**





360° Installability™

360<sup>+1</sup>

- Sturdy cabinet
- 15" wide control box
- External gauge ports
- Service trays
- Integrated lift receptacles (Optional)
- Easy handling
- No sharp edges
- 10.5" High-Slim Air Handlers
- Convertible return air arrangement
- Provision for ½" & 1" filter
- Easy Hi/Lo voltage hookup
- Flexibility in drain connection

**FIGURE 17**  
**FILTER REMOVAL**

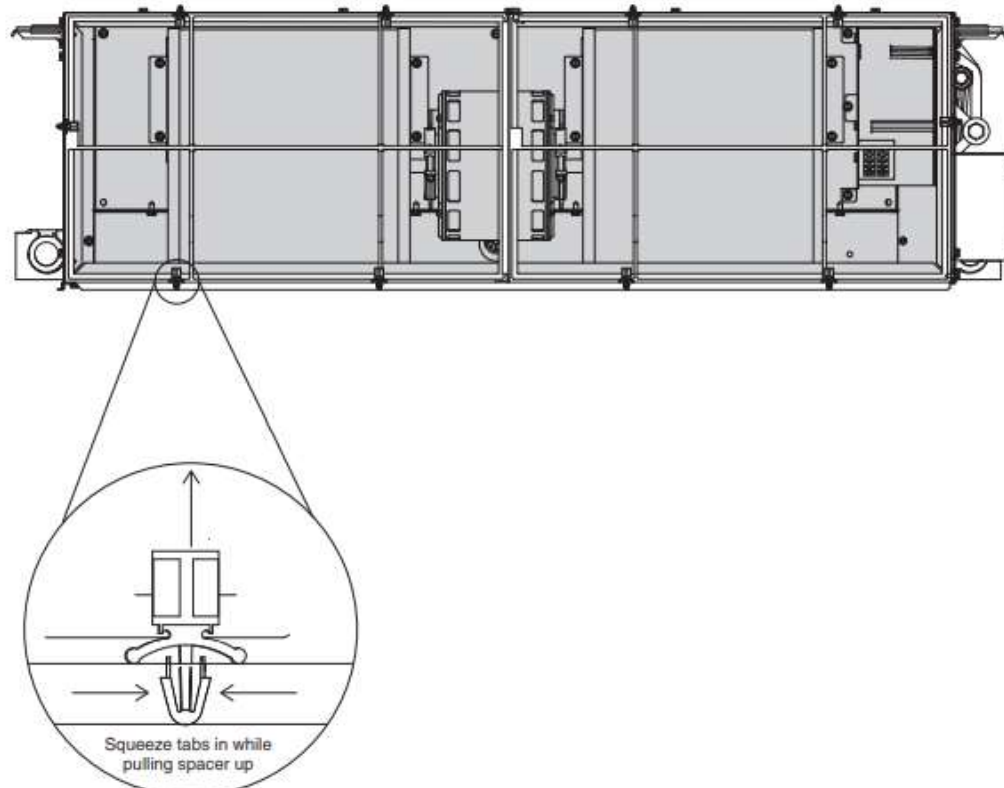

FILTER REMOVAL as shown in Figure 17, remove the white plastic filter retention clips so that the filters can be removed without the need of any tools (see Figure 17 on how to remove the filter retention clips)



360° Installability™

360<sup>+1</sup>

Sturdy cabinet  
15" wide control box  
External gauge ports  
Service trays  
Integrated lift receptacles  
(Optional)  
Easy handling  
No sharp edges  
10.5" High-Slim Air Handlers  
Convertible return air  
arrangement  
Provision for ½" & 1" filter  
Easy Hi/Lo voltage hookup  
Flexibility in drain connection

Model	Length (Inch)	Height (Inch)	Qty.
18	16.6	10.1	1
22	16.6	10.1	1
28	22.6	10.1	1
32	22.6	10.1	1
42	18.35	11.125	2
48	24.9	11.125	2
55	24.9	11.125	2
65	24.9	11.125	2

## Piston / TXV

- TXV is in Indoor Unit
- No need to insulate liquid pipe
- Piston up to model 32
- TXV in models 42/48/55/65



PARKER

TXV

- Better cooling at high ambient
- Reliable: Protect Compressor from liquid



360° Installability™

360<sup>+1</sup>

- Sturdy cabinet
- 15" wide control box
- External gauge ports
- Service trays
- Integrated lift receptacles (Optional)
- Easy handling
- No sharp edges
- 10.5" High-Slim Air Handlers
- Convertible return air arrangement
- Provision for ½" & 1" filter
- Easy Hi/Lo voltage hookup
- Flexibility in drain connection

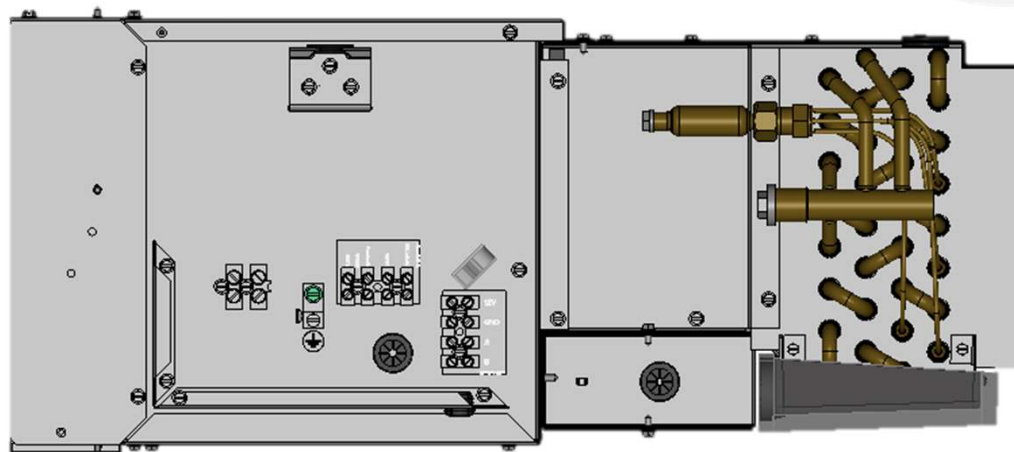

EASILY ACCESSIBLE Electrical connections  
Field Connections separately on side  
Easy to access

**Benefit :**

- **Ease of access**
- **Simple field connections**



360° Installability™

360<sup>+1</sup>

Sturdy cabinet  
15" wide control box  
External gauge ports  
Service trays  
Integrated lift receptacles  
(Optional)  
Easy handling  
No sharp edges  
10.5" High-Slim Air Handlers  
Convertible return air  
arrangement  
Provision for ½" & 1" filter  
Easy Hi/Lo voltage hookup  
**Flexibility in drain connection**

## DRAIN PAN

Drain connection provision on both sides

### **Benefit :**

- Flexibility in installation
- Saves space



360° Installability™

360<sup>+1</sup>





360° Installability™

360°<sup>+1</sup>

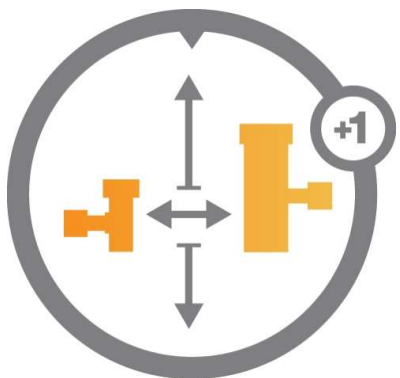

PlusOne™  
**Filter provisions**  
(1/2" , 1")



### Feature

- Standard unit has provision to accommodate ½" and 1" filters (field supplied)
- Separate locking spaces for different size filter

### Benefits

- Flexibility of changing filter size in field
- No need to order separate unit from factory



360° Serviceability™

360<sup>+1</sup>

**Bottom removable filter**

- Ease of access -Electricals
- Ease of access-Drain Pan
- Removable fan deck
- Diagnosis-Error codes
- Corner service access
- Diagnostic service window
- Filter Drier
- 35% less fasteners
- Single row coils
- Service friendly outdoor fan
- Smart Component placement
- Easy disassembly/re-assembly

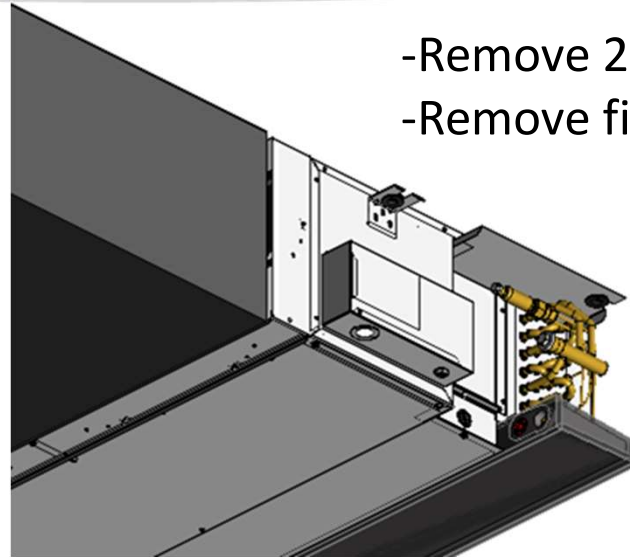

- Remove 2 screws
- Remove filter door, then filter

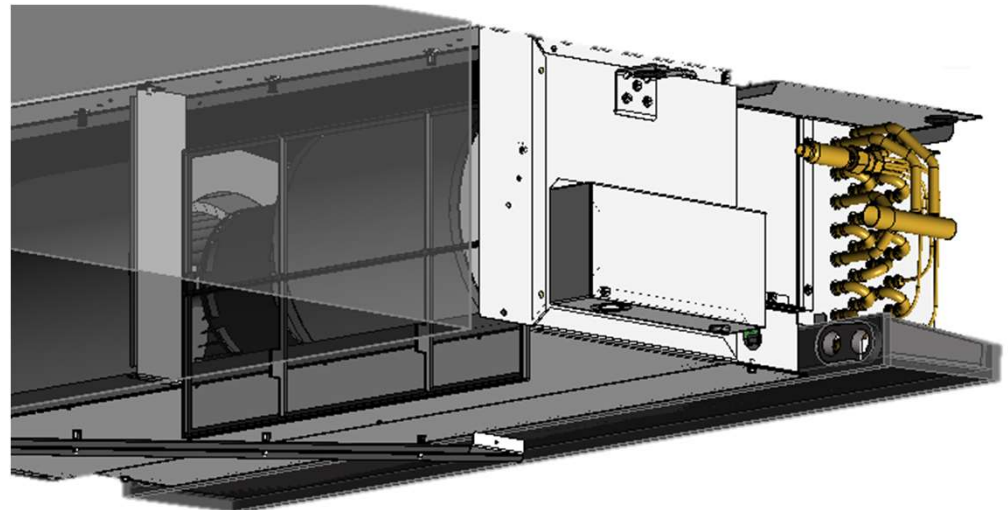

**Benefit :**

- Easy filter cleaning in case of return air ducting





360° Serviceability™

360<sup>+1</sup>

## SERVICEABILITY

Bottom removable filter  
Ease of access -Electricals  
Ease of access-Drain Pan  
Removable fan deck  
Diagnosis-Error codes  
Corner service access  
Diagnostic service window  
Filter Drier  
35% less fasteners  
Single row coils  
Service friendly outdoor fan  
Smart Component placement  
Easy disassembly/re-assembly

- Compressor : Can be easily removed after removing the top panel.
- Complete Electrical section is accessible through service panel.



### Benefit :

- Ample space to access electrical connections
- Saves time to service



360° Serviceability™

360<sup>+1</sup>

Bottom removable filter  
Ease of access -Electricals  
**Ease of access-Drain Pan**  
Removable fan deck  
Diagnosis-Error codes  
Corner service access  
Diagnostic service window  
Filter Drier  
35% less fasteners  
Single row coils  
Service friendly outdoor fan  
Smart Component placement  
Easy disassembly/re-assembly



## EASILY ACCESSIBLE DRAIN PAN

Easy access for servicing & cleaning purpose through bottom under installed condition without disturbing the installation of the unit.

### **Benefit :**

- Less time required to clean drain pan
- Can be serviced without stopping the unit



360° Serviceability™

360<sup>+1</sup>

Bottom removable filter  
Ease of access -Electricals  
Ease of access-Drain Pan  
**Removable fan deck**  
Diagnosis-Error codes  
Corner service access  
Diagnostic service window  
Filter Drier  
35% less fasteners  
Single row coils  
Service friendly outdoor fan  
Smart Component placement  
Easy disassembly/re-assembly

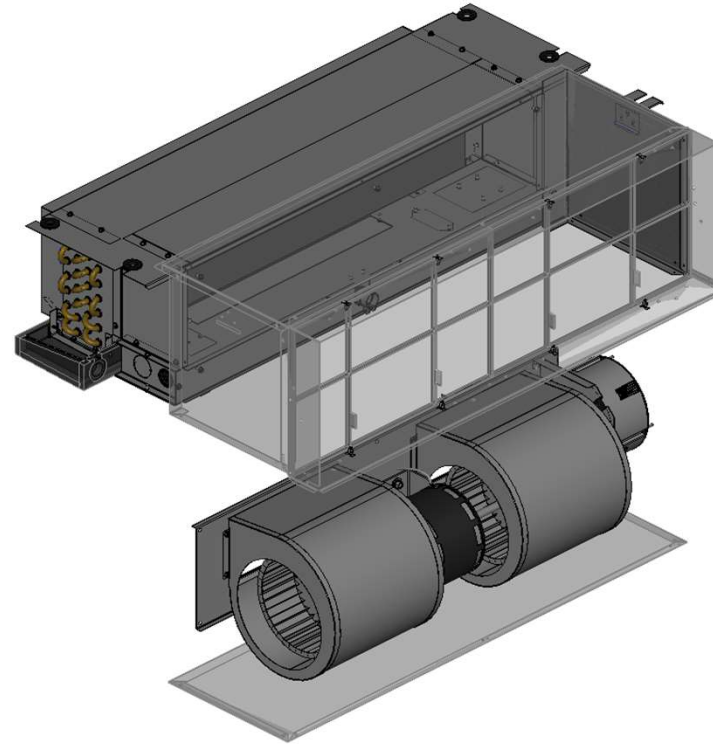

## Blower Motor Access

Easily removable blower motor assembly from bottom

### **Benefit :**

- Easy to service
- Time saving



360° Serviceability™

360<sup>+1</sup>

Bottom removable filter  
Ease of access -Electricals  
Ease of access-Drain Pan  
Removable fan deck  
**Diagnosis-Error codes**  
Corner service access  
Diagnostic service window  
Filter Drier  
35% less fasteners  
Single row coils  
Service friendly outdoor fan  
Smart Component placement  
Easy disassembly/re-assembly

## Diagnosis codes

---

Diagnosis codes on thermostat

- HP/LP
- Anti Freeze
- Loss of communication
- Sensor fault
- Lock out

### **Benefit :**

- Easy diagnosis
- System protection



360° Serviceability™

360<sup>+1</sup>

- Bottom removable filter
- Ease of access -Electricals
- Ease of access-Drain Pan
- Removable fan deck
- Diagnosis-Error codes
- Corner service access
- Diagnostic service window
- Filter Drier
- 35% less fasteners
- Single row coils
- Service friendly outdoor fan
- Smart Component placement
- Easy disassembly/re-assembly



- ✓ Control box
- ✓ Service valves
- ✓ Service window





360° Serviceability™

360<sup>+1</sup>

- Bottom removable filter
- Ease of access -Electricals
- Ease of access-Drain Pan
- Removable fan deck
- Diagnosis-Error codes
- Corner service access
- Diagnostic service window**
- Filter Drier
- 35% less fasteners
- Single row coils
- Service friendly outdoor fan
- Smart Component placement
- Easy disassembly/re-assembly



- ✓ Access to TXV (HP)
- ✓ Access to reversing valve (HP)
- ✓ Access to high/low pressure (AC)
- ✓ Access to temperatures (HP)
- ✓ Unit operation while off



360° Serviceability™

360<sup>+1</sup>

Bottom removable filter  
Ease of access -Electricals  
Ease of access-Drain Pan  
Removable fan deck  
Diagnosis-Error codes  
Corner service access  
Diagnostic service window

#### Filter Drier

35% less fasteners  
Single row coils  
Service friendly outdoor fan  
Smart Component placement  
Easy disassembly/re-assembly

## FILTER DRIER

- Filter drier is supplied loose as standard accessory with the units for installation in liquid line in field.
- The filter drier prevents the unwanted moisture in the system and help in enhancing the life of the system.



### **Benefit :**

- External installed drier – easy to service



360° Serviceability™

360<sup>+1</sup>

- Bottom removable filter
- Ease of access -Electricals
- Ease of access-Drain Pan
- Removable fan deck
- Diagnosis-Error codes
- Corner service access
- Diagnostic service window
- Filter Drier
- 35% less fasteners**
- Single row coils
- Service friendly outdoor fan
- Smart Component placement
- Easy disassembly/re-assembly



9 on top  
0 on bottom





## One Row Condenser Coil

Easy to wash and clean

No dust trap concern like two row coils

- Bottom removable filter
- Ease of access -Electricals
- Ease of access-Drain Pan
- Removable fan deck
- Diagnosis-Error codes
- Corner service access
- Diagnostic service window
- Filter Drier
- 35% less fasteners
- Single row coils
- Service friendly outdoor fan
- Smart Component placement
- Easy disassembly/re-assembly



### **Benefit :**

- Better performance
- Long life of condenser



360° Serviceability™

360<sup>+1</sup>

- Bottom removable filter
- Ease of access -Electricals
- Ease of access-Drain Pan
- Removable fan deck
- Diagnosis-Error codes
- Corner service access
- Diagnostic service window
- Filter Drier
- 35% less fasteners
- Single row coils
- Service friendly outdoor fan**
- Smart Component placement
- Easy disassembly/re-assembly





# 360° Serviceability™

# 360<sup>+1</sup>

- Bottom removable filter
- Ease of access -Electricals
- Ease of access-Drain Pan
- Removable fan deck
- Diagnosis-Error codes
- Corner service access
- Diagnostic service window
- Filter Drier
- 35% less fasteners
- Single row coils
- Service friendly outdoor fan
- Smart Component placement**
- Easy disassembly/re-assembly

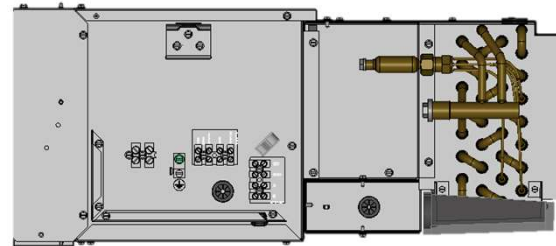

Main power connections

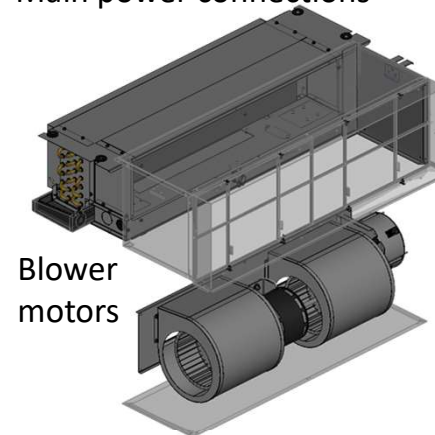

Blower motors

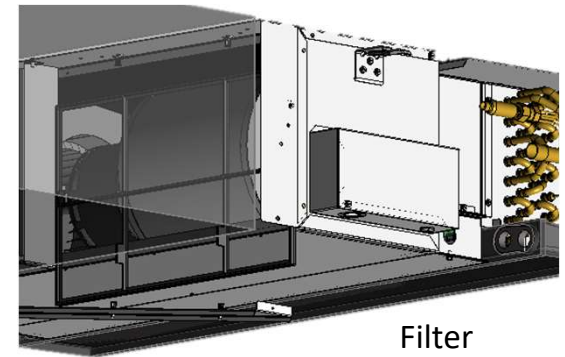

Filter

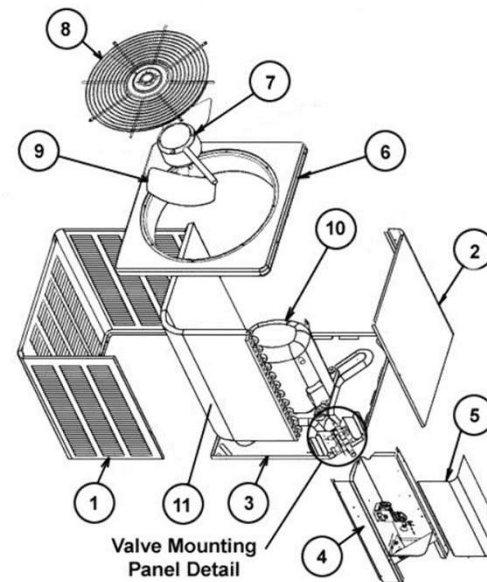

Valve Mounting Panel Detail

- All components position aptly selected.
- Heavy components like compressor, motor in center to balance the unit

### Benefit :

- Overall very easy to access and service



360° Serviceability™

360<sup>+1</sup>

- Bottom removable filter
- Ease of access -Electricals
- Ease of access-Drain Pan
- Removable fan deck
- Diagnosis-Error codes
- Corner service access
- Diagnostic service window
- Filter Drier
- 35% less fasteners
- Single row coils
- Service friendly outdoor fan
- Smart Component placement
- Easy disassembly/re-assembly

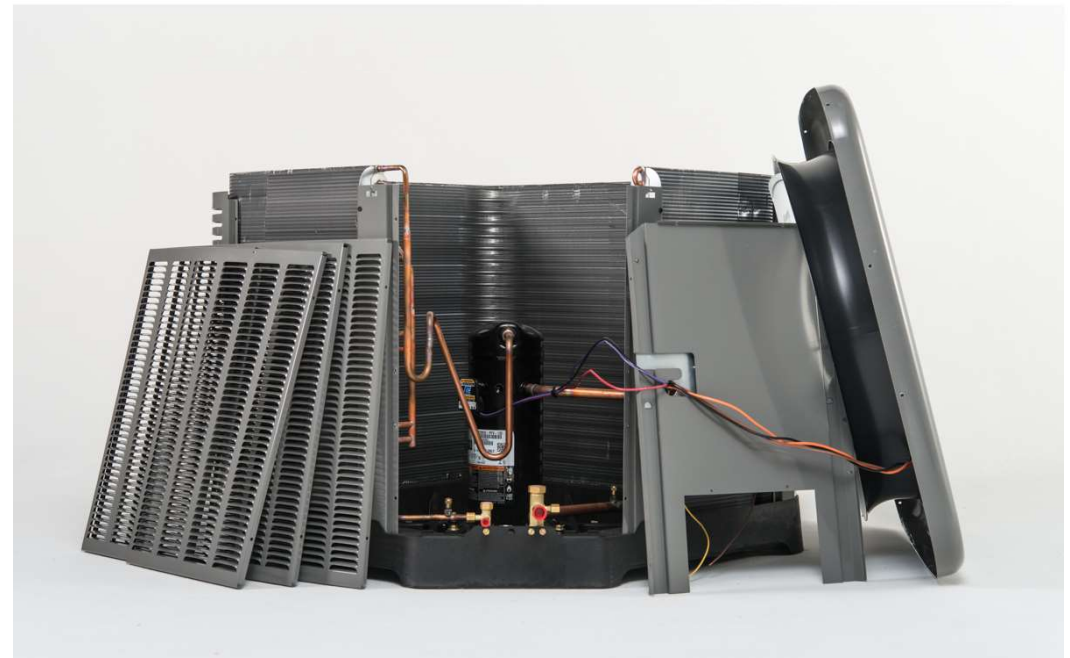



360° Serviceability™

360<sup>+1</sup>





360° Serviceability™

360<sup>+1</sup>

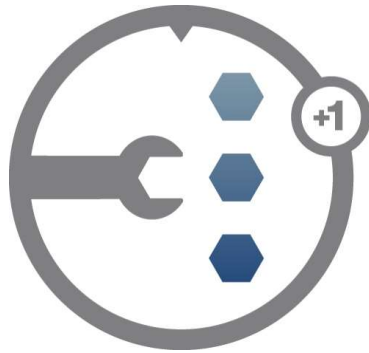

PlusOne™  
Triple Service Access



## Feature

- Triple Service Access maximizes **Serviceability™** by providing easy access to all components

## Benefits

- 15" wide control box access opens by removing two fasteners
- Two fastener removable corner allowing ideal access to units internal components
- Single fastener to remove louver panel for easy coil cleaning





# Country of Origin

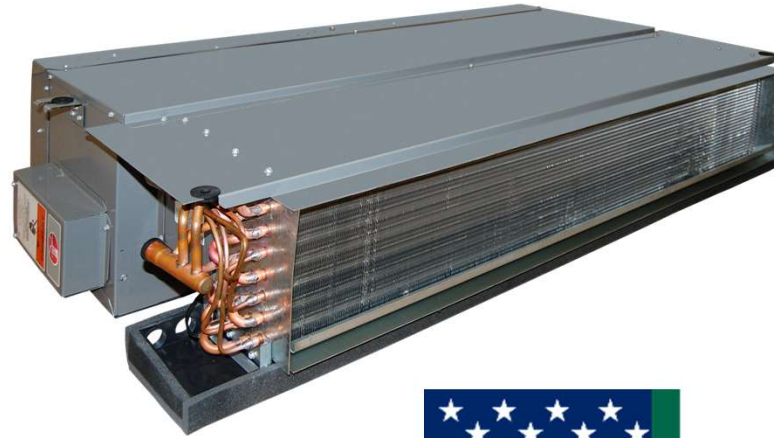

Indoor Unit



Outdoor Unit



**PROUDLY MADE IN  
NORTH AMERICA**